



ICFS 

INDO CONSTRUCTION FASTENING SYSTEMS



**NYLON
FRAME PLUG**

www.indospark.com

Nylon Frame Plug NFP

Polymide PA6 nylon - steel, zinc plated



Description

The nylon frame plug NFP provides a professional and secure method for the fixing of doors and window frames. It has an elongated nylon plug body incorporating a countersunk collar and is supplied complete with heavy gauge screw in either countersunk or hexagonal head.

Advantages

- Special anti-expansion design lets the user drive both plug and screw into the hole together, without the plug expanding before it is fully inserted.
- Side-links stop plug from breaking open during insertion, ensuring positive action when screw is driven in.
- Screw guide stops screw from penetrating sides, by ensuring positive tracking down entire length.
- M-teeth combined with side-links and screw-guide, ensure entire plug face is forced against walls of hole, for enhanced grip in soft materials.
- Offset block profile allows plug to hold firmly against sides of hole when expansion begins.
- Countersunk collar reduces risk of bi-metallic corrosion when fastening non-ferrous fixtures.
- Nylon material absorbs vibration and noise.
- Extended expansion length guarantees maximum load-bearing capacity.

Advice

For installations in perforated and hollow bricks drill with a rotary action only(hammer switched off)

Base Material

Short expansion plug recommended for use in concrete, natural stone and brick. Extended expansion plug is recommended for use in hollow brick, gypsum aerated concrete and sandstone.

Applications

Ideal for timber battens, wooden batten, skirting, facade and roof substructures, metal and plastic, window and doorframes, metal profiles, fireproof doors, panels and cladding.

Installation

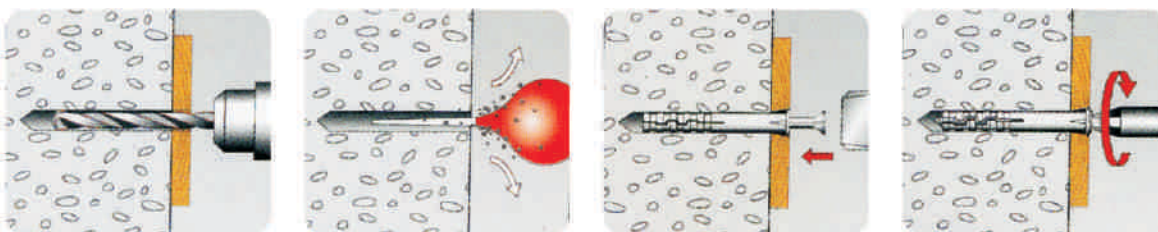

Variant short expansion-cskscrew
Material polyamide PA6 nylon

NFP - SC



Product code	Plug Size	Plug length (mm)	Screw thread diameter (mm)	Hole depth through work piece	Fastening Thikness (mm)	Package content
NFP08060SC	M08	60	5	70	10	100
NFP08080SC	M08	80	5	90	30	100
NFP08100SC	M08	100	5	110	50	100
NFP08120SC	M08	120	5	130	70	50
NFP08140SC	M08	140	5	150	90	50
NFP10080SC	M10	80	6	90	30	50
NFP10100SC	M10	100	6	110	50	50
NFP10120SC	M10	120	6	130	70	50
NFP10140SC	M10	140	6	150	90	50
NFP10160SC	M10	160	6	170	110	50

Variant short expansion-hex head
Material polyamide PA6 nylon

NFP - SH



Product code	Plug Size	Plug length (mm)	Screw thread diameter (mm)	Hole depth through work piece(mm)	Fastening Thikness (mm)	Package content
NFP08060SC	M08	60	5	70	10	100
NFP08080SC	M08	80	5	90	30	100
NFP08100SC	M08	100	5	110	50	100
NFP08120SC	M08	120	5	130	70	50
NFP08140SC	M08	140	5	150	90	50
NFP10080SC	M10	80	6	90	30	50
NFP10100SC	M10	100	6	110	50	50
NFP10120SC	M10	120	6	130	70	50
NFP10140SC	M10	140	6	150	90	50
NFP10160SC	M10	160	6	170	110	50

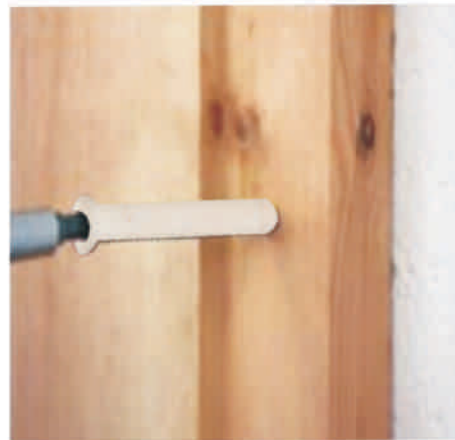

Nylon Hammer Fixing Plug NHF

Polymide PA6 nylon - steel, zinc plated/ stainless steel / A2-304



Description

The nylon hammer fixing plug NHF is a time saving hammer-in nylon plug with pre-assembled zinc plated nail-screw. The nylon hammer fixing plug NHF expands when the nail is driven in, and holds by friction in the drill hole. Suitable for most types of base materials. Long expansion area, nail-screw with reinforced neck and pozidrive head. Fixture can easily be removed. The nylon hammer fixing plug NHF is available with two different styles of head. The countersunk head NHF-CK is for countersunk fix in thick materials and the cylindrical head NHF-CY is for round head fix in thin materials also available with 304 stainless nail for corrosive environments.

Advantages

- Deforming crumple zone allows for quick adjustment of depth on uneven surfaces.
- Brand point allows for quick and easy insertion of the Hammer plug into the pre-drilled hole.
- Long expansion area provides a more efficient fix even in light weight aerated concrete.
- Off-set block profile ensures that as plug expansion commences, it is held firm against the hole.
- Knock in protection prevents premature expansion when driving in the screw, yet makes it possible to adjust the depth of plug in the hole.
- Position of the nail in front of the thread start permits easy drive in facility yet allows excellent screw out qualities for possible removal and re-use.
- Oblique thread using the barbed hook principle achieves good pull out figures without sacrificing speed of application.
- Reinforced screw head facilitates high knock-in loads with the added benefit of grip around the plug neck holding the material firm.

Base Material

Recommended for use in dense concrete, natural stone, lightweight concrete, brickwork and aerated concrete blocks.

Applications

Ideal for mounting frames, skirting boards, wood battens, pipe clips, cable ducts, angles, brackets & fittings needing many mounting points.

Installation

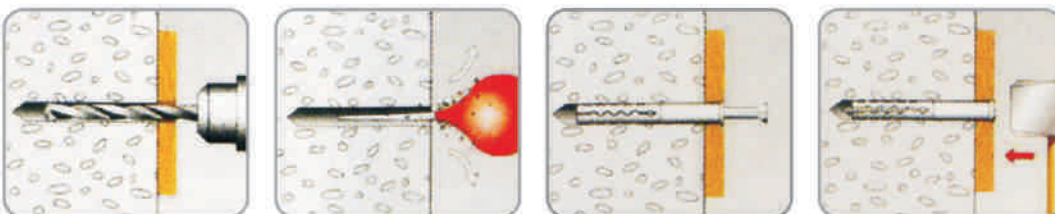

Nylon Hammer Fixing Plug NHF - CK

Variant countersunk head
Material polyamide PA6 nylon



Product code	Plug Size	Plug length (mm)	Hole depth through work piece(mm)	Fastening Thickness (mm)	Package content
NHF5040CK	M05	40	50	15	100
NHF6040CK	M06	40	50	10	100
NHF6060CK	M06	60	70	30	100
NHF6080CK	M06	80	90	50	100
NHF8060CK	M08	60	70	20	50
NHF8080CK	M08	80	90	40	50
NHF8100CK	M08	100	110	60	50
NHF8120CK	M08	120	130	80	50
NHF8140CK	M08	140	150	100	50

Nylon Hammer Fixing Plug NHF - CY

Variant cylindrical head
Material polyamide PA6 nylon
A2-304 screw



Product code	Plug Size	Plug length (mm)	Hole depth through work piece(mm)	Fastening Thickness (mm)	Package content
NHF5040CY	M05	40	50	15	100
NHF6040CY	M06	40	50	10	100
NHF6060CY	M06	60	70	30	100
NHF6080CY	M06	80	90	50	100
NHF8060CY	M08	60	70	20	50
NHF8080CY	M08	80	90	40	50
NHF8100CY	M08	100	110	60	50
NHF8120CY	M08	120	130	80	50
NHF8140CY	M08	140	150	100	50



Nylon Plug FD

Polymide PA6 nylon



Description

The nylon plug NP is considerably stronger than standard grade plastic expansion plugs, these high quality wall plugs are designed for use with all screw fixings in masonry and concrete. High impact load and knock in protection prevents distortion on installation. Winged to prevent rotation in the drill hole.

Advantages

- Suitable for wood and chipboard screws.
- Sid-links stop plug from breaking open during insertion, ensuring positive action when screw is driven in.
- Screw guide stops screw from penetrating sides, by ensuring positive tracking down entire length.
- M-teeth combined with side-links and screw-guide, ensure entire plug face is forced against walls of hole, for enhanced grip in soft materials.
- Offset block profile allows plug to hold firmly against sides of hole when expansion begins.
- The wide neck is subject to no expansion pressure and prevents surface damage to tiles and plaster.
- Can be used with wood and chipboard screws from 2.5mm to 12mm.

Base Material

Short expansion plug is recommended for use in concrete, natural stone and brick. Highly recommended for use in all solid materials building including lightweight concrete, brickwork and aerated concrete blocks.

Applications

Ideal for fixing pictures, motion detector, lamps, skirting, electric switches, small wall-mounted shelves, towel rails, lightweight mirror cabinets, letterboxes, hanging baskets and curtain rails.



Variant flush head
Material polyamide PA6 nylon

Nylon plug - FD



Product code	Plug Size	Plug length (mm)	Screw thread diameter (mm)	Screw length (mm)	Hole diameter (mm)	Hole depth (mm)	Package content
FD0420	M04	20	2.5 - 3.0	25	4	25	200
FD0525	M05	25	3.0 - 4.0	30	5	35	200
FD0630	M06	30	4.0 - 5.0	40	6	40	200
FD0737	M07	37	4.0 - 5.5	45	7	50	100
FD0840	M08	40	4.5 - 6.0	50	8	55	100
FD1050	M10	50	6.0 - 8.0	60	10	70	50
FD1260	M12	60	8.0 - 10.0	70	12	80	25
FD1470	M14	70	10.0 - 12.0	80	14	90	20



Nylon Plug (Polyamide 6)

Performance Data



Testing NFP - Nylon Frame Fixing Plug

Material - Nylon (Polyamide 6)				
Diameter (mm)	10	10	10	10
Length (mm)	100	120	140	160
Drilling Diameter (mm)	10	10	10	10
Min. Drilling Depth (mm)	110	130	150	170
Min. Drilling Depth (mm)	110	130	150	170
Min. Installation length (mm)	100	120	140	160
Max. Using Length (mm)	20	35	55	80
Pull out tension value non cracked concrete (kN)	2.50	2.50	2.50	2.50
Pull out tension value cracked concrete (kN)	1.62	1.62	1.62	1.62
Pull out tension value light concrete (kN)	1.50	1.50	1.50	1.50
Pull out tension value areated concrete (kN)	0.70	0.70	0.70	0.70



Testing NHF - Nylon Hammer Fixing Plug

Material - Nylon (Polyamide 6)										
Diameter (mm)	5	6	6	6	8	8	8	8	8	8
Length (mm)	40	40	60	80	60	80	100	120	140	160
Drilling Diameter (mm)	5	6	6	6	8	8	8	8	8	8
Min. Drilling Depth (mm)	50	50	70	90	70	90	110	130	140	170
Max. using length (mm)	10	10	30	50	20	40	60	80	100	120
Min. Anchoring Depth (mm)	30	30	30	30	40	40	40	40	40	40
Pull out tension value non cracked concrete (kN)	0.40	0.60	0.60	0.60	1.00	1.00	1.00	1.00	1.00	1.00
Pull out tension value cracked concrete (kN)	0.26	0.39	0.39	0.39	0.65	0.65	0.65	0.65	0.65	0.65

Testing FD-Plug



Material - Nylon (Polyamide 6)									
Diameter (mm)	4	5	6	8	10	12	14	16	20
Length (mm)	20	25	30	40	50	60	70	80	90
Drilling Diameter (mm)	4	5	6	8	10	12	14	16	20
Min. Drilling Depth (mm)	25	30	40	50	60	70	80	90	100
Min. Installation Depth (mm)	20	25	30	40	50	60	70	80	90
Screws (mm)	2-3	2,5-4,0	3,5,-5,5	4,5-6,0	6,0-8,0	8,0-10,0	10,0-12,0	12,0-14,0	16,0
Pull out tension value non cracked concrete (kN)	0.42	0.50	0.75	2.18	2.20	2.60	3.00	4.00	5.50
Pull out tension value cracked concrete (kN)	0.26	0.32	0.45	1.40	1.43	1.70	1.95	2.60	3.50
Sandstone brick (kN)	0.29	0.36	0.84	0.61	5.12	-	-	-	-

This information should be regarded as general recommendations. More specifically, please note that these plug and anchors may not be used for work subject to building inspections.(for securing facade substructures roof etc.)

*Safety factor 5





CHANNEL PARTNER

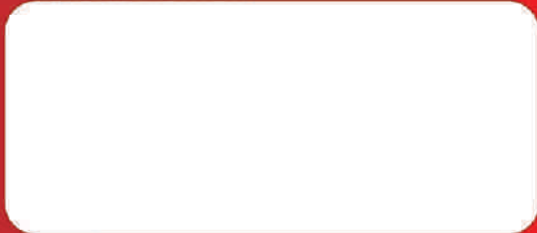

CORPORATE OFFICE

198, E ward, Tararani Chowk,
Near Geeta Mandir,
Kolhapur-416 003 (Mah. India)
Tel.: 0231-2653908.
Email : mail@indospark.com

BRANCH

Islampur | Pune | Mumbai



FOLLOW US



www.shop.indospark.com